

ENGINE

Model	Cummins QSB 6.7, Tier III certified electronic control
Type	4-stroke, turbocharged and air to air after cooled
Cylinders	6, in-line
Bore/Stroke	4.09 in x 5.20 in (104 x 132 mm)
Displacement	411 in ³ (6.7 L)
Fuel injection	Common rail
Fuel	Diesel
Cooling	Liquid
Horsepower per SAE J1995	
Gross	220 hp (164 kW) @ 2200 rpm
Net	205 hp (153 kW) @ 2200 rpm
Maximum torque @ 1500 rpm	
Net	650 ft-lbs (881 N-m)

POWERTRAIN

Rear axle	Planetary
Differential	Hydraulic lock, operator controlled
Outboard brakes	Wet disc
Number of discs/brake	5
Brake surface area	1,560 in ² (10 089 cm ²)
Tandems –	
Type	Welded plate
Oscillation	20° each way
Front axle	High strength, welded steel
Oscillation	19° each direction
Wheel lean	17.5° left/right
Tires	14.0 x 24 12PR TL G2 Firestone
Rims	1-piece 9 in x 24 in (227 x 610 mm)

HYDRAULICS

Type	Closed center, load sensing
Hydraulic pump	Load sensing piston pump, variable displacement, pressure and flow compensated
Rated flow @ 2200 rpm	49 gpm (187 L/min)
Control valve	9 section
Side shift and pitch	Hydraulic
Saddle	5 positions
Diagnostic quick couplers	8

ALL WHEEL DRIVE-HYDRAULICS

Type	Closed center
Hydraulic pump	Load sensing piston pump, variable displacement, pressure flow compensated
Rated flow @ 2200 rpm	37.9 gpm (143.5 L/min)
Maximum operating pressure	6,092 PSI (420 Bar)
Drive motors	2

TRANSMISSION

Type	Direct drive countershaft powershift w/ electronic shift control and inching pedal
Pump flow @ 2200 rpm	24 gpm (91 L/min)
Sump	Integral
Speeds	n/a
Shifting	Single lever, bump style automatic electronic control
Diagnostics	Onboard
Speeds– mph (km/h) –	
Forward	
1st	2.39 (3.86)
2nd	3.18 (5.47)
3rd	4.68 (7.56)
4th	6.58 (10.62)
5th	9.58 (15.45)
6th	13.47 (21.73)
7th	19.0 (30.64)
8th	26.7 (43.0)
Reverse	
1st	2.39 (3.86)
2nd	4.68 (7.56)
3rd	9.58 (15.45)
4th	19.0 (30.64)

ELECTRICAL

Voltage	24 volts, negative ground
Alternator	80 amp 45 amp (optional)
Batteries (2)	Low-maintenance 750 CCA – 100 Ah (20 hr rate)
Lighting –	
Headlights (2); Turn signals, front/rear; Stop/tail (2); Rear mounted floods (2); Front mounted floods (2); moldboard worklights (2)	
Backup alarm	Standard

STEERING

Type	Hydrostatic power steering
Turns (lock-to-lock)	4.75
Pump capacity @ 2200 engine rpm	11.5 gpm (43.4 L/min)
Relief pressure	2,200 psi (151 bar) integral with priority valve
Cylinder (2) –	
2.5 in bore x 10.5 in stroke x 1.5 in rod dia. (63.5 mm x 266.7 mm x 38.1 mm)	
Supplemental steering	Integral (Not applicable when equipped with 20.5 x 25 tires)

ARTICULATION

Type	Hydraulic actuated (with lock valve)
Range	25° left/right
Controls	Hydraulic

SERVICE CAPACITIES

Engine	4.4 gal (17.5 L)
w/filter change	4.7 gal (18.5 L)
Fuel	90 gal (341 L)
Transmission	5.0 gal (23 L)
w/filter change	6.6 gal (25 L)
Radiator	10.5 gal (40 L)
Hydraulic reservoir	25 gal (94.6 L)
Hydraulic system	50.2 gal (190 L)
Circle gearbox	3 qt (2.8 L)
Rear axle center	3.2 gal (12 L)
Total axle	4.9 gal (18.5 L)
Tandem case, each	6 gal (22.7 L)

MAINFRAME

Type	All welded box
Front section —	
Size	10.0 in x 11.73 in (254 x 298 mm)
Weight	124.7 lbs-ft (172.8 kg/m)
Rear section —	
Size	4.75 in x 11.75 in (121 x 299 mm)
Weight (each side)	76.8 lbs-ft (114.2 kg/m)

DRAWBAR

Type	"A" frame welded construction with center mounted circle turn motor
Ball and circle	Shim adjustable

MOLDBOARD

Type	High-carbon steel
Shape	Involute curve
Length	14 ft 0 in (4267 mm)
Height	23.6 in (600 mm)
Thickness	0.875 in (22.2 mm)
End bits	2, interchangeable
Blade pitch positions —	
Normal pitch	47°
Minimum pitch	42°
Maximum pitch	87°
Blade shift —	
Right	27.0 in (686 mm)
Left	21.0 in (533 mm)
Max. bank cutting angle (right and left):	90°
Ground penetration (max.)	28 in (711.2 mm)
Lift above ground (max.)	17.5 in (444.5 mm)

CIRCLE

Type	Welded construction
Diameter —	
Max. outside	69.0 in (1752.6 mm)
Vertical member	63.0 in (1600.2 mm)
Rotation	360°
Speed	1.1 rpm (6.8°/second)
Drive	Hydraulic motor
Type	Roller Geroter
Displacement	14.5 in ³ /Rev. (0.24 L/Rev)
Rated hydraulic flow	25 gpm (94.6 L/min)

OPERATING WEIGHT

With 14 ft (4.27 m) moldboard, 175 lb (79 kg) operator, full fuel and standard equipment	37,950 lb (17 250 kg)
Weight, front axle	11,227 lb (5103 kg)
Weight, rear axle	26,723 lb (12 147 kg)
Blade pressure	20,095 lb (9134 kg)

ATTACHMENTS

SCARIFIER

Type	Front mounted
Width of cut	46 in (1168 mm)
Teeth	5 (11 optional)
Tooth spacing	9.0 in (229 mm) (4.5 in optional)
Lift above ground	20.75 in (527 mm)
Max. penetration	12.5 in (318 mm)
Weight	1,256 lb (570 kg) (includes front attachment group)

PUSH BLOCK

Type	Front mounted
Weight	1,084 lb (492 kg)

REAR RIPPER

Type	Parallel
Ripper teeth	3 (5 optional)
Scarifier teeth	5 (9 optional)
Width of cut	86.4 in (2195 mm)
Lift above ground —	
Ripper teeth	20.38 in (518 mm)
Scarifier teeth	27.67 in (703 mm)
Max. penetration —	
Ripper teeth	17.22 in (437 mm)
Scarifier teeth	9.43 in (252 mm)
Weight	2,167 lb (985 kg)

DOZER BLADE

Type	Front mounted
Width	109 in (2762 mm)
Height	37.5 in (953 mm)
Lift above ground	24.5 in (622 mm)
Penetration	6.5 in (165 mm)
Weight	2,568 lb (1165 kg) (includes front attachment group)

COUNTERWEIGHT

Type	Front mounted
Weight	1,084 lb (492 kg)

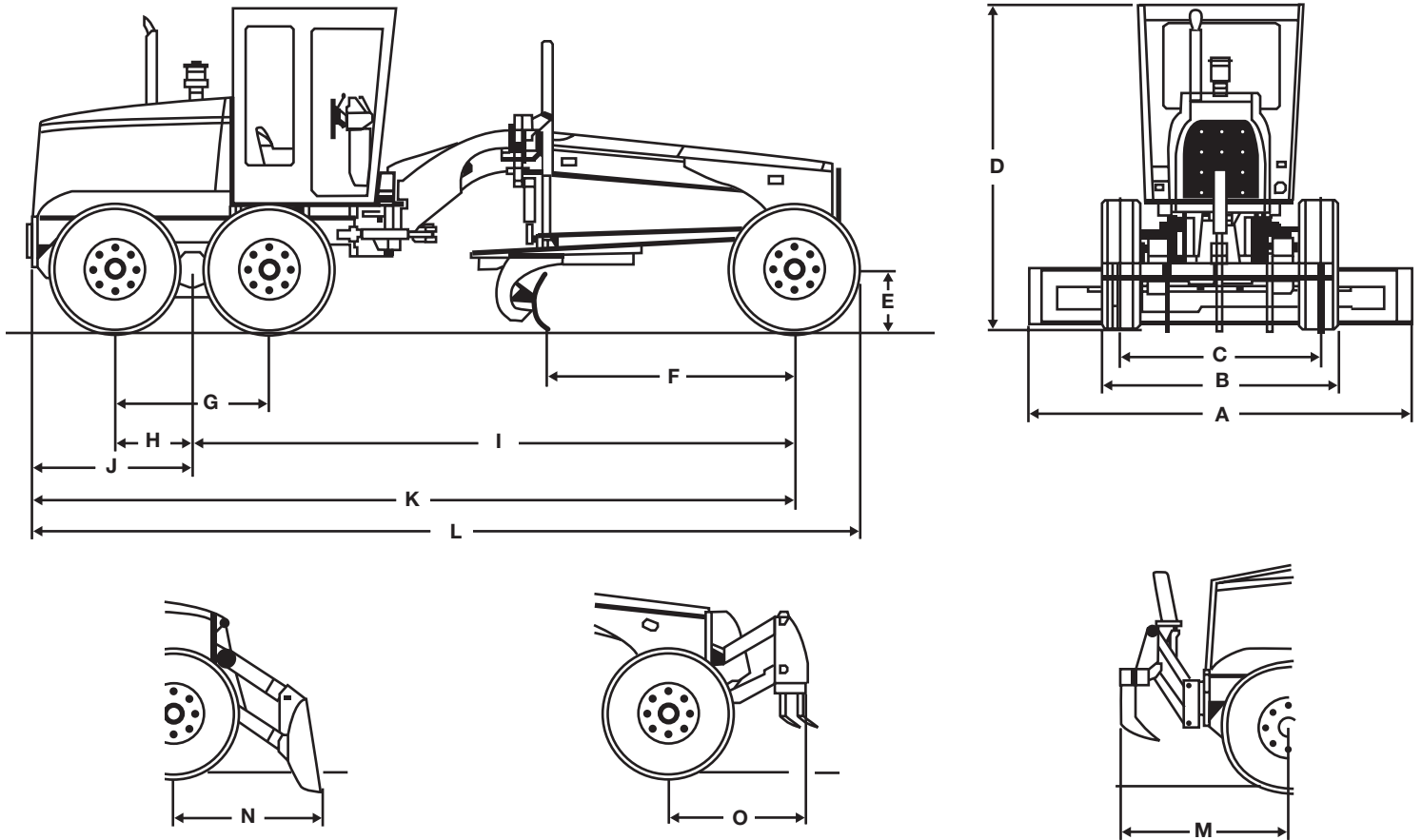

Line drawings are for illustrative purpose only and may not be exact representation of unit.

DIMENSIONS

		885
A.	Blade width	14 ft 0 in (4267 mm)
B.	Distance between outside edges of tires	8 ft 8 in (2650 mm)
C.	Wheel tread	7 ft 0 in (2134 mm)
D.	Height to top of cab	10 ft 11 in (3340 mm)
D.	Height to top of cab — low profile	10 ft 4 in (3150 mm)
E.	Tire radius — when static	2 ft 0 in (610 mm)
F.	Blade base	8 ft 5 in (2562 mm)
G.	Distance between tandem axles	5 ft 3 in (1602 mm)
H.	Distance between tandem center and wheel	2 ft 7.5 in (801 mm)
I.	Wheelbase	20 ft 5 in (6219 mm)
J.	Distance between tandem center and rear end of machine	5 ft 5 in (1650 mm)
K.	Distance between front axle and rear end of machine	25 ft 10 in (7874 mm)
L.	Overall length	28 ft 0 in (8534 mm)
M.	Distance between rear tires & rear ripper	6 ft 8 in (2040 mm)
N.	Distance between front tires & front scarifier	5 ft 0 in (1524 mm)
O.	Distance between front tires & front dozer blade	5 ft 5 in (1645 mm)
	Outside tire turning radius	23 ft 11 in (7289 mm)
	Ground clearance (rear axle)	14.9 in (380 mm)
	Ground clearance (front axle)	24.5 in (622 mm)

All units equipped with 14.0 x 24-10 PR tires, ROPS cab with heater & A/C, std. battery, full fuel, 175 lb (79 kg) operator. Specifications per JISO. 7134.

STANDARD EQUIPMENT

OPERATOR'S COMPARTMENT

ROPS cab (SAE J231-ISO 3449)
Adjustable operator's console
Adjustable cloth suspension seat with
3 in (76 mm) retractable seat belt
Front/rear wipers w/washer
Safety glass
Dome light
Inside rear view mirror
Outside rear view mirrors
Sunshade – front & rear
Cup holder
Storage tray
12-volt outlet
Ashtray
Radio ready (12 volt)
Master switch
Heater/defroster/pressurizer
Air conditioner
Sound suppression - 77 dBA in cab
Cab doors - left/right
Steps - left/right
Steering wheel knob

POWERTRAIN

Hydraulic differential lock

ENGINE

Cummins QSB 6.7 turbocharged diesel
Tier III certified
Charge air cooler

HYDRAULICS

Closed center, load sensing hydraulic system
Controls for all functions
9 section control valve
Front attachment piping
Hydraulic moldboard side shift and pitch
5-position saddle
14 ft x .875 in (4267 x 22 mm) moldboard
Rear pull hook
8 hydraulic diagnostic quick couplers
Hydraulic driven cooling fan

TIRES

14.0 x 24-12 PR

INSTRUMENTS

Analog LED Instruments:

Speedometer; Tachometer; Gear shift display; Hourmeter; Engine oil pressure; Engine coolant temperature; 6 WD (optional); Creep speed (optional)

Monitor Functions:

Engine oil pressure; Engine coolant temperature; Transmission oil pressure; Transmission oil temperature; Transmission filter restriction; Brake oil pressure; Battery voltage; Hourmeter; Tachometer; Parking brake applied; Air and hydraulic oil filter restriction; Hydraulic oil temperature; Emergency flashers; High beams; Supplemental steering

ELECTRICAL

Batteries (2)
Electronic Systems Monitor
Horn
Alternator, 80 amp
Backup alarm

OPTIONAL EQUIPMENT

POWERTRAIN

All wheel drive with creep speed

MOLDBOARDS

12 ft x .875 in (3658 x 22 mm)
Extensions - 2 ft (610 mm)
Front Float Control
Moldboard Float Control
Lift cylinder/side shift accumulator
Lift cylinder accumulator

TIRES

14.0 x 24 XGLA
16.0 x 24-12 PR
17.5 x 25-12 PR
20.5 x 25-12 PR

ELECTRICAL

Heavy duty batteries 1010 CCA

OTHER

Reversing cooling fan
Temperature controlled cooling fan
Fire Extinguisher
Front lower windshield washer and wiper
Strobe Light
Tool Box (w/o tools)
Deluxe Tool Box (w/tools)
Cab recirculation fans

NOTE: All specifications are stated in accordance with SAE Standards or Recommended Practices, where applicable.

NOTE: All engines meet current EPA emissions requirements.

IMPORTANT: CNH America LLC reserves the right to change these specifications without notice and without incurring any obligation relating to such change. CNH America LLC does not warrant the safety or reliability of attachments from other manufacturers.

Case is a registered trademark of CNH America LLC. Any trademarks referred to herein, in association with goods and/or services of companies other than CNH America LLC, are the property of those respective companies.



www.casece.com